

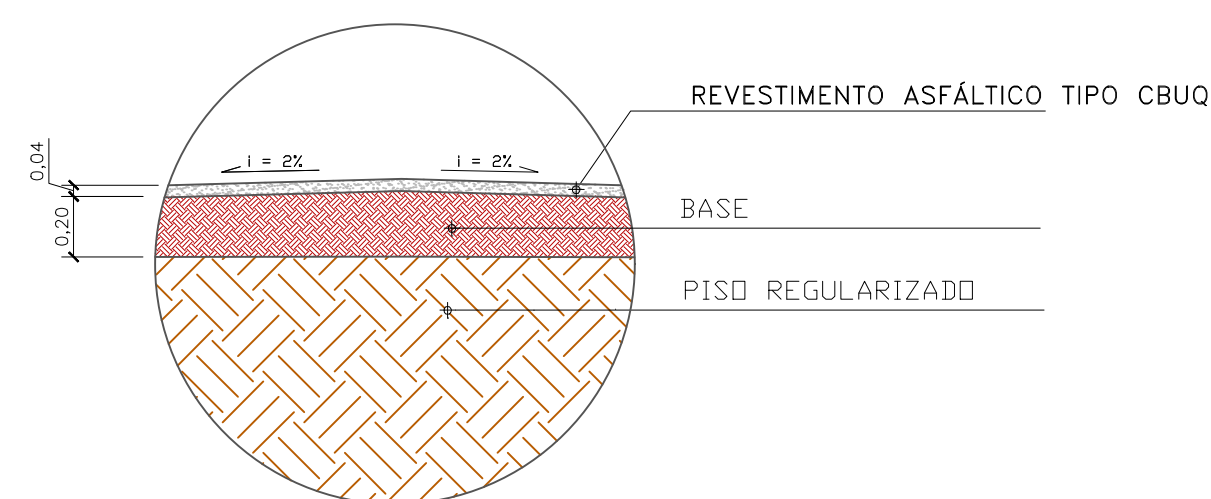

CORTE TRANSVERSAL PISTA DE ROLAMENTO
-REVESTIMENTO ASFÁLTICO EM CBUQ
ESCALA 1 / 25

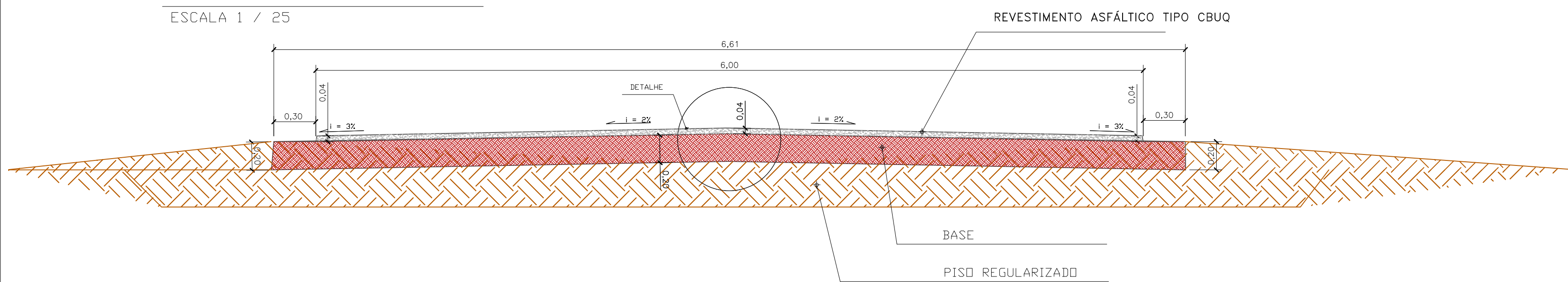

DETALHE - CORTE CAMADAS
SEM ESCALA

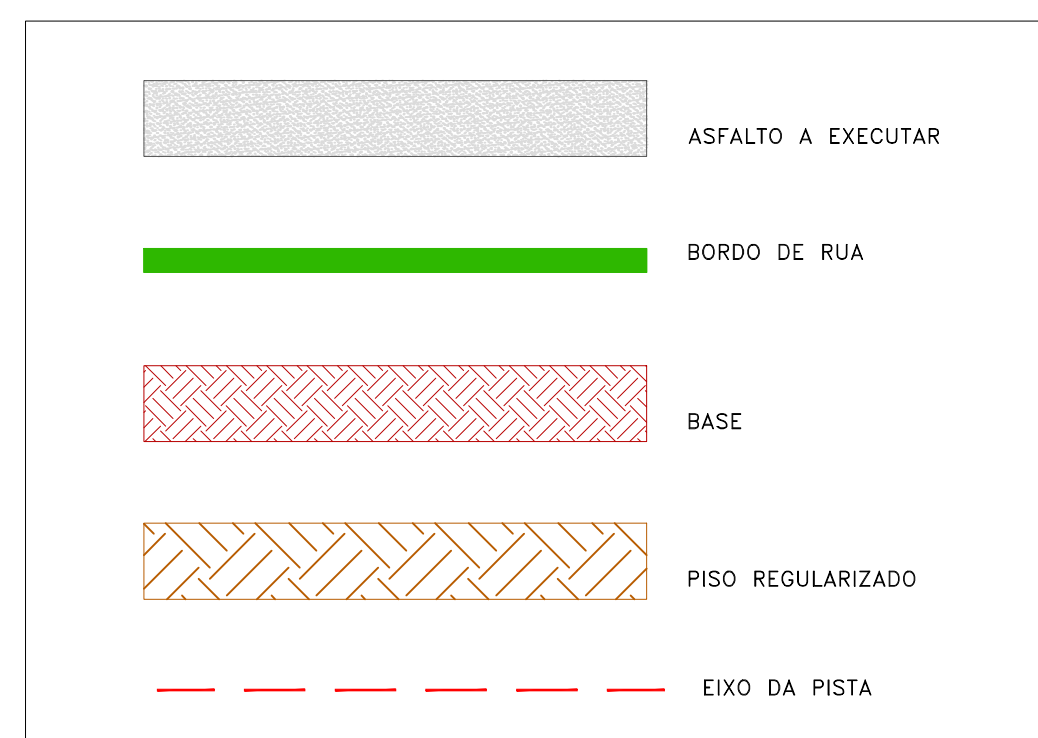
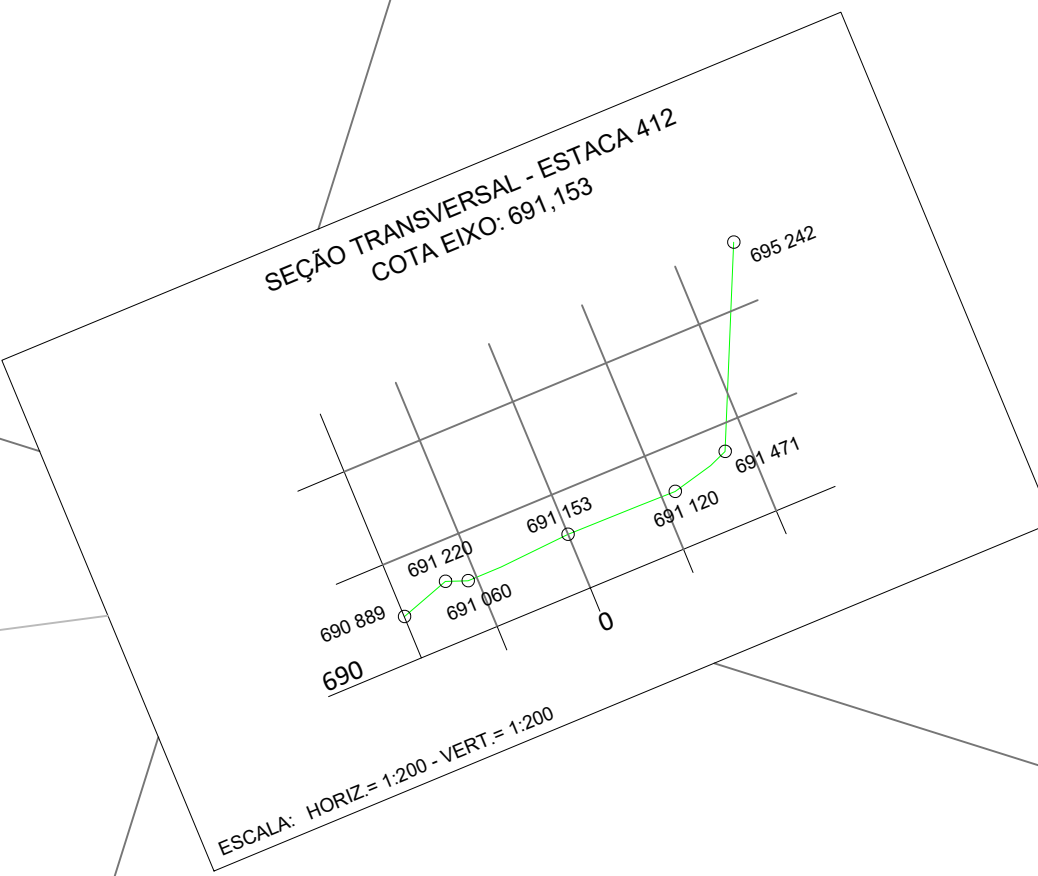
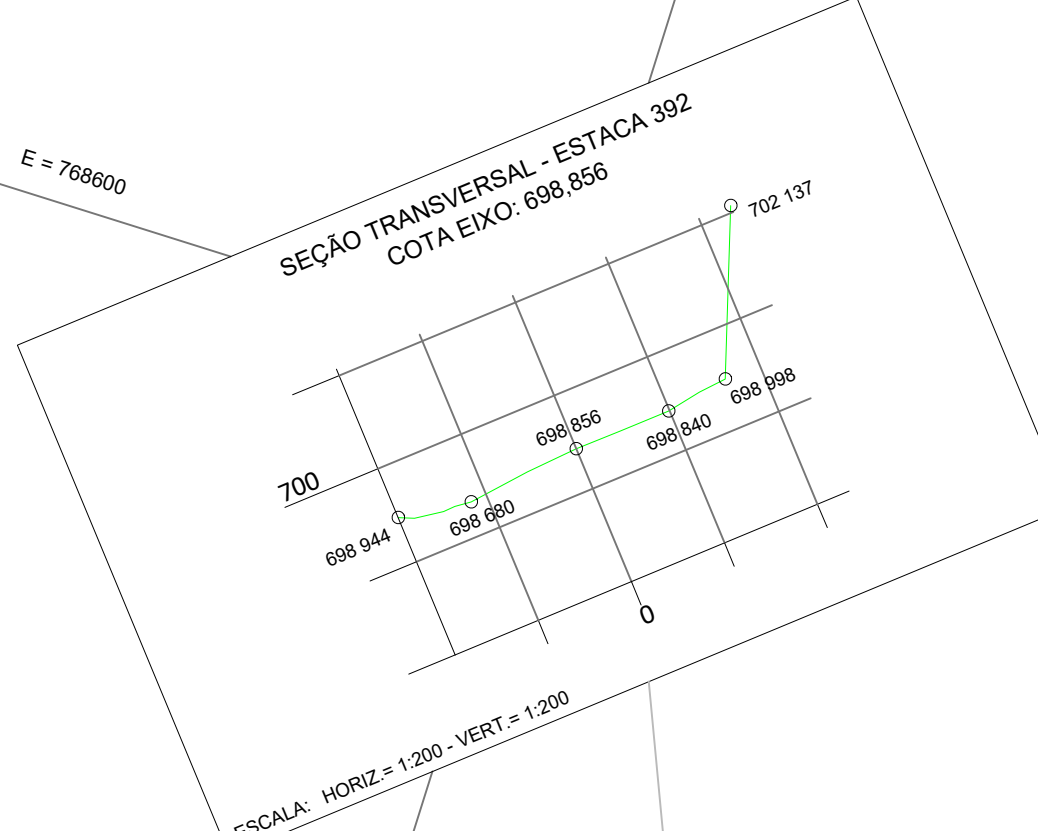
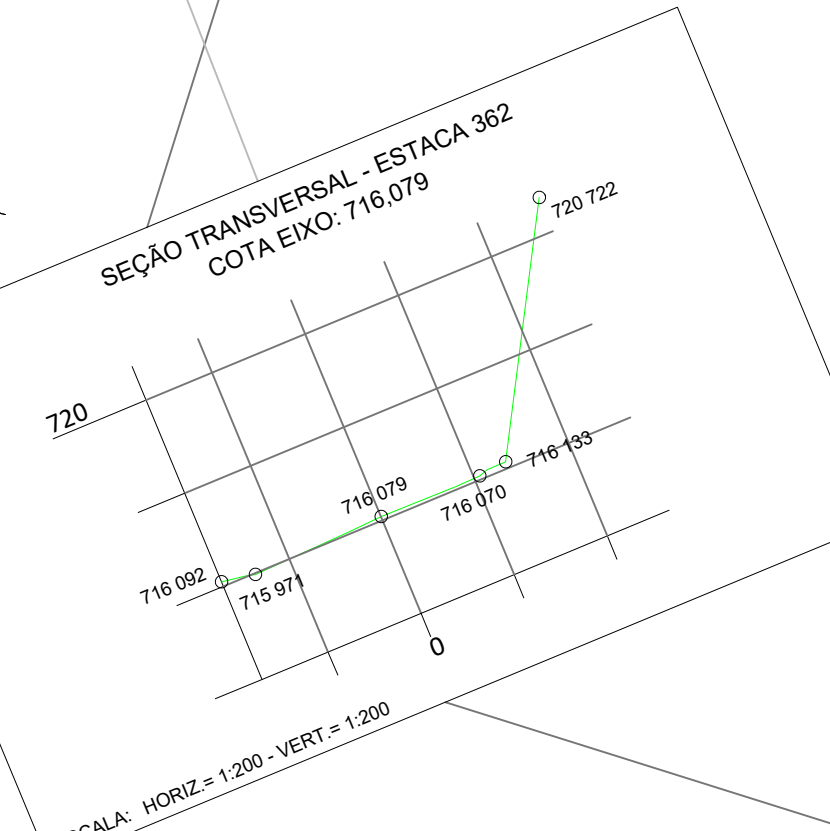
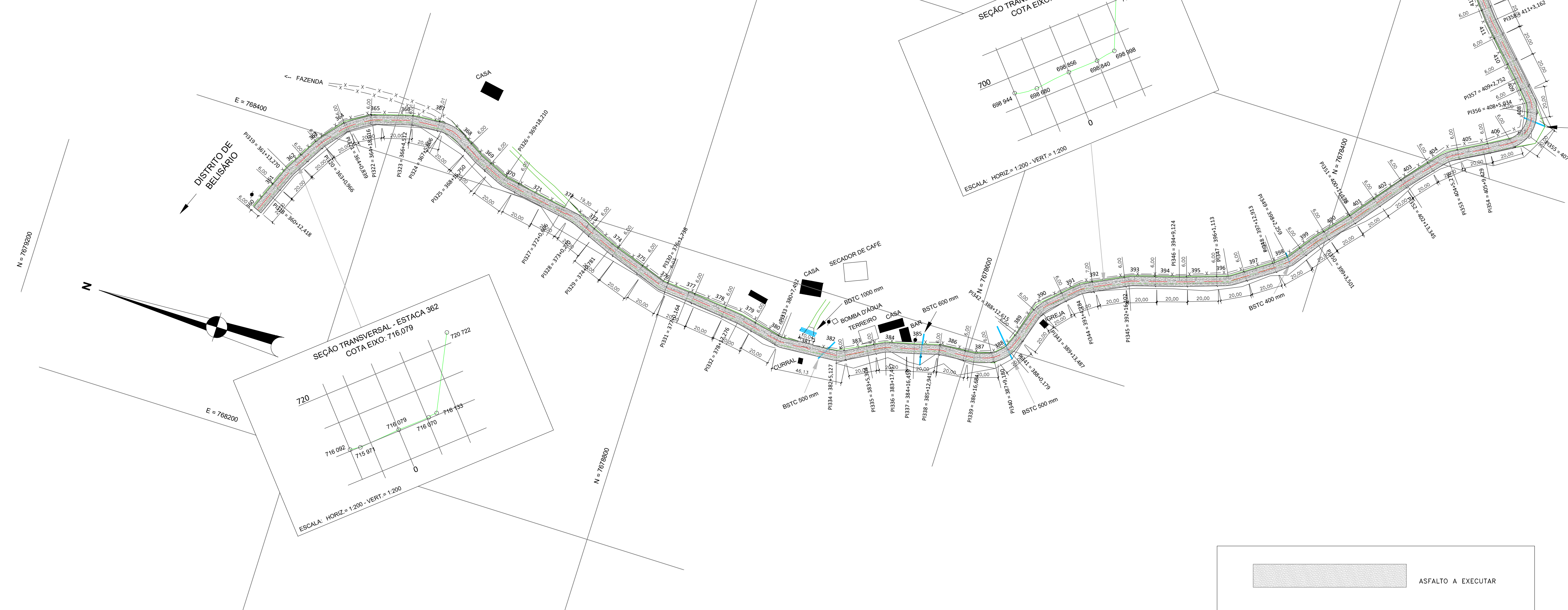

PLANTA BAIXA
ESC. 1/1500

 SECRETARIA MUNICIPAL DE OBRAS PUBLICAS		 PREFEITURA DE MURIAÉ Terra Querida	
DESCRIÇÃO: PAVIMENTAÇÃO DE ESTRADA			
LOCAL: ESTRADA DO DISTRITO DE ITAMURI AO DISTRITO DE BELISARIO MURIAE-MG		ESPECIE: REVESTIMENTO ASFÁLTICO TIPO CBUQ	
PREFEITURA MUNICIPAL DE MURIAÉ / CNPJ: 13.847.581/0001-76		ESCALA: INDICADA	DATA: ABRIL/2022
JOSÉ BRAZ - PREFEITO MUNICIPAL		ESTACA: est. - 432-360	
SECRETARIO MUNICIPAL DE OBRAS: CARLOS GERALDO ROCHA KNEIP		AREAS: EXTENSÃO MÉDIA DA RUA: 1,440 ml LARGURA MÉDIA DA RUA: 6,00 ml ÁREA A SER CALÇADA: 8,640,00 m²	
Responsável Técnico: ARLAN DO CARMO MENDONÇA - ENGH CIVIL CREA 177324D/MG		ARQUIVO: DWG	FORMATO: EST.
		PRANCHAS: A1	05